



RISK MANAGEMENT & PURCHASING
1140 EAST PARKER STREET
LAKELAND, FL 33801

ADDENDUM NO. 6
INVITATION TO BID
CONSTRUCTION OF A NEW OFFICE BUILDING AT 114 E. PARKER STREET

FOR
LAKELAND COMMUNITY REDEVELOPMENT AGENCY

September 9, 2020

BID NO. 0252

The purpose of this addendum is to advise all interested parties of the following revisions and/or clarifications and to transmit the information as noted below:

1. **Question: Could a specification be provided for carpet tile and ceramic tile? See revised Addendum #6 (attached)**
2. **Bid Due Date has been EXTENDED: 3:30 p.m. –Friday – September 18, 2020**

As COVID-19 significantly impacts the community, we want to reassure you that the health and safety of our citizens and City staff is extremely important to us. As such, we will not have a public bid opening for solicitations while the City of Lakeland has issued a Declaration of State of Emergency. We will continue to publish bid tabulations as the City’s standard business practice dictates. We appreciate your cooperation and attention in this matter.

To listen to the meeting, please call 1 (408) 650-3123, input the access code 637-477-165 and press #.

Note: All addenda shall be acknowledged in the Bid submittal, therefore please sign the bottom of this page ** and return with the Bid submittal.

All other items remain unchanged.

Linda Alspaugh

Linda Alspaugh
Purchasing Agent

Cc: Terrilyn Bostwick – Alis Drumgo – D’Ariel Reed
File

****ADDENDUM #6 is hereby “ACKNOWLEDGED”**

_____/_____/_____/_____
Signature / Title / Company Name / Date



FURR,
WEGMAN &
BANKS
Architects, P.A. (AA0003150)

19-59/Pg. A6-01
09/09/2020

ADDENDUM NO. 06

To the Plans and Specifications For

CRA 114 E. Parker Street New Office Building
114 E. Parker Street
Lakeland, FL 33801

FURR, WEGMAN & Banks ARCHITECTS, P.A.

625 East Orange Street, Lakeland, Florida 33801

Phone: (863) 688-1211

Fax: (863) 688-1473

Make the following corrections and/or additions to the Plans.

DRAWINGS:

Item A6-01 Sheet A112 Finish Floor Plan

1. At Finish Schedule Legend, indicate "basis of design" carpet and tile.
2. At Room Finish Schedule, modify wall base material for rooms 102, 104, 105 & 106.

Submitted by:

M. Aaron Banks, AIA
FURR, WEGMAN & BANKS ARCHITECTS, P.A.

09/09/2020
Date

END OF ADDENDUM NO. 06

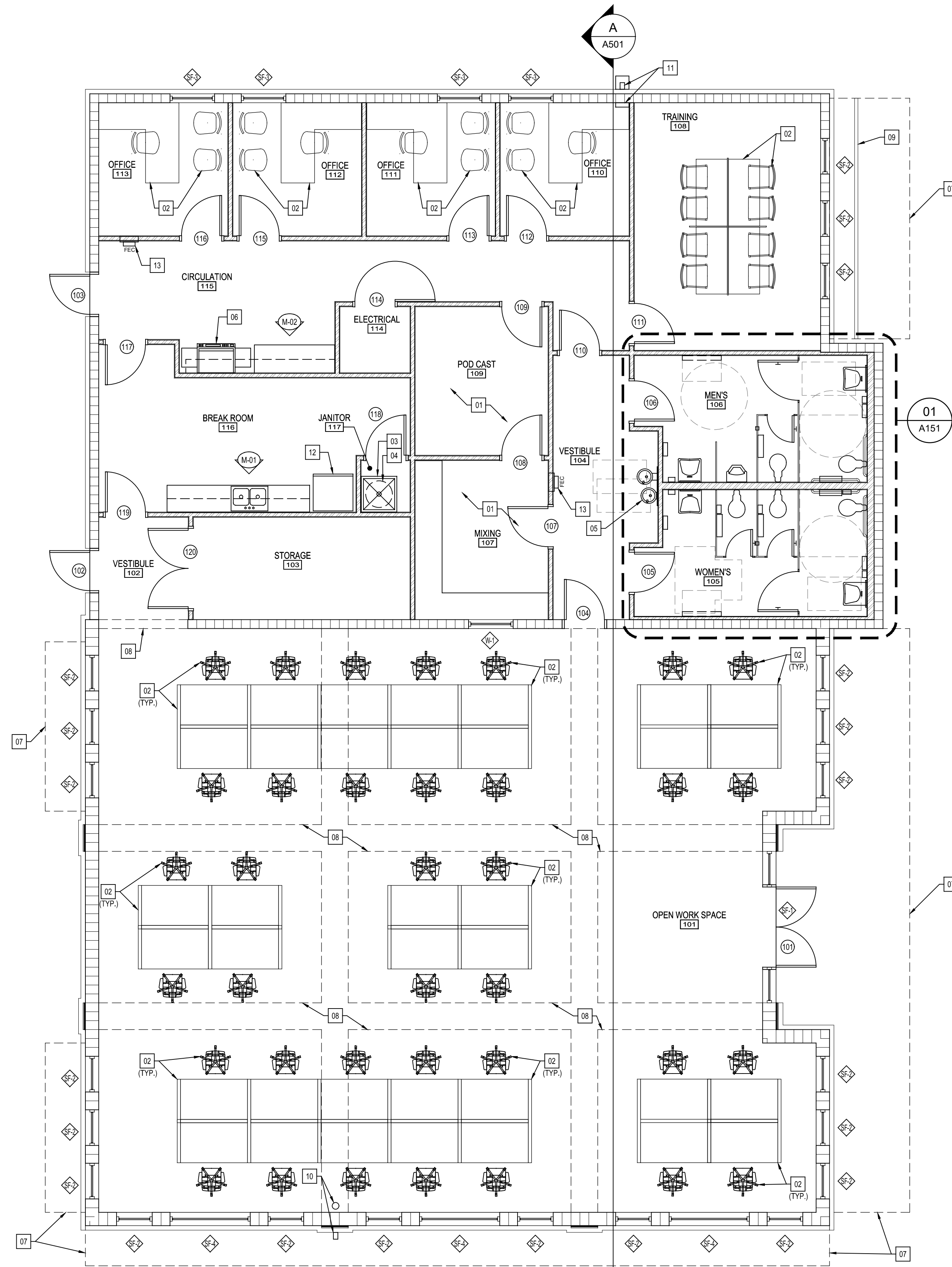

FINISH FLOOR PLAN
SCALE: 3/16" = 1'-0"

FINISH SCHEDULE LEGEND	
ABBREVIATION	DESCRIPTION
FLOOR	
SC	SEALED CONCRETE
PC	POLISHED CONCRETE FINISH
CT	CERAMIC TILE - EQUAL TO DALTILE KEYSTONES 1X1 MOSAIC
CPT	CARPET TILE - EQUAL TO PATRCRAFT ARTIFACT COLLECTION
BASE	
V	VINYL BASE
CT	CERAMIC TILE COVE BASE W/ FLAT TOP - EQUAL TO DALTILE COLOR WHEEL COL. LINEAR 4 1/4 X 12 7/8
W	WOOD BASE - PAINTED (SEE SHEET A141)
WALLS	
MP1	MASONRY, PAINTED
MP2	MASONRY W/ LITE ORANGE PEEL FINISH (PAINTED) & STRUCK HORIZONTAL MASONRY JOINTS @ 2'-0" O.C.
GP	GYPSON BOARD PANEL - USE MOISTURE RESISTANT AT TOILET ROOMS AND JANITOR CLO.
CT	CERAMIC TILE - EQUAL TO DALTILE COLOR WHEEL COLLECTION LINEAR 4 1/4 X 12 7/8 - FULL HEIGHT
FRP	FIBERGLASS REINFORCED PANEL - UP TO 4'-2" A.F.F.
CEILING	
ACT	7/2" LAY-IN ACOUSTICAL TILE
GP	GYPSON BOARD, PAINTED
EXP	EXPOSED STRUCTURE, PAINTED

ROOM FINISH SCHEDULE									
ROOM NO.	ROOM NAME	FLOOR	BASE	WALLS				CEILING	NOTES
				N	S	E	W		
101	OPEN WORK SPACE	PC	W	MP2	MP2	MP2	MP2	EXP/GP	VARIABLES --
102	VESTIBULE	PC	W	GP	GP	MP1	GP	ACT	9'-0"
103	STORAGE	SC	V	GP	MP1	GP	GP	ACT	9'-0"
104	VESTIBULE	PC	W	GP	MP1	GP	GP	ACT	10'-0"
105	WOMEN'S	CT	WCT	GP	CT	CT	GP	GP	9'-0"
106	MEN'S	CT	WCT	GP	CT	CT	GP	GP	9'-0"
107	MIXING	CPT	V	GP	MP1	GP	GP	ACT	9'-0"
108	TRAINING	CPT	V	MP1	GP	MP1	GP	ACT	10'-0"
109	POD CAST	CPT	V	GP	GP	GP	GP	GP	9'-0"
110	OFFICE	CPT	V	MP1	GP	GP	GP	GP	9'-0"
111	OFFICE	CPT	V	MP1	GP	GP	GP	GP	9'-0"
112	OFFICE	CPT	V	MP1	GP	GP	GP	GP	9'-0"
113	OFFICE	CPT	V	MP1	GP	GP	MP1	GP	9'-0"
114	ELECTRICAL	SC	V	GP	GP	GP	GP	EXP	VARIABLES
115	CIRCULATION	PC	V	GP	GP	GP	MP1	ACT	10'-0"
116	BREAK ROOM	PC	V	GP	GP	GP	MP1	ACT	9'-0"
117	JANITOR	SC	V	GP	GP/FRP	GP	GP/FRP	GP	8'-0"

NOTES:
1. SOUND ATTENUATION INSULATION ABOVE CEILING.

KEYNOTES	
01.	SOUNDPROOFING ON WALLS (BY OWNER).
02.	FURNITURE (BY OWNER).
03.	MOP SINK: SEE PLUMBING DRAWINGS.
04.	WATER HEATER (ABOVE). SEE PLUMBING DRAWINGS.
05.	HIGH/LOW ELECTRIC WATER COOLER. SEE PLUMBING DRAWINGS.
06.	COPIER (BY OTHERS).
07.	LINE OF PRE-FABRICATED METAL CANOPY ABOVE.
08.	LINE OF GYP. SOFFIT ABOVE.
09.	GARDEN SCREENWALL SYSTEM.
10.	FIRE RISER WITH EXTERIOR DISCHARGE OUTLET PIPE.
11.	FIRE SPRINKLER TEST STATION VALVE WITH EXTERIOR DISCHARGE OUTLET PIPE AND SPLASHBLOCK.
12.	REFRIGERATOR (BY OTHERS).
13.	SEMI-RECESSED FIRE EXTINGUISHER CABINET.

FINISH FLOOR PLAN
CRA 114 E. PARKER STREET
NEW OFFICE BUILDING

114 E PARKER STREET
LAKELAND, FL 33801

PHASE: 100% CONSTRUCTION DOCUMENTS

DATE	REVISION DESCRIPTION - THIS SHEET ONLY
07/21/2020	ADDENDUM NO. 01
09/09/2020	ADDENDUM NO. 06

DATE: 05/28/2020

PROJ. MGR. **KAG** CKD BY: **MAB**

JOB NUMBER: **19-59**

SHEET NUMBER: **A112**